

Series CA5 & Series CAU5 (Contactors & Reversing Contactors)

Dimensions are in millimeters (inches). Dimensions not intended for manufacturing purposes.

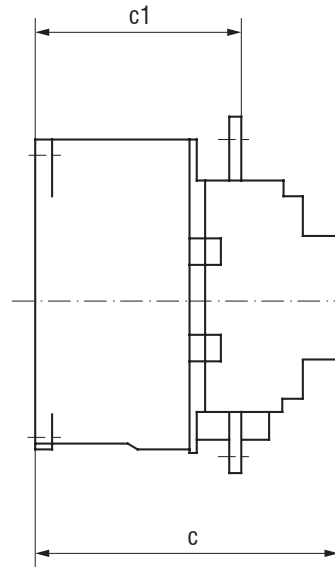
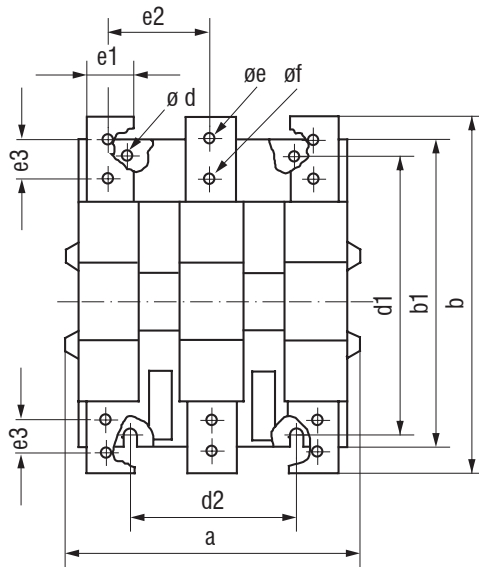

Type	a	b	b1	c	c1	ød	d1	d2	øe	øf	e1	e2	e3
CA5-550	220 (8-21/32)	258 (10-5/32)	228 (8-31/32)	225 (8-7/8)	164 (6-7/16)	9 (3/8)	220 (8-21/32)	110 (4-5/8)	13 (17/32)	-	40 (1-19/32)	79 (3-1/8)	-
CA5-700	280 (11-1/32)	307 (12-3/32)	277 (10-29/32)	291 (11-15/32)	203 (8)	11 (7/16)	280 (11-1/32)	175 (6-7/8)	13 (17/32)	-	50 (1-31/32)	101 (4)	-
CA5-860	280 (11-1/32)	361 (14-7/32)	325 (12-25/32)	291 (11-15/32)	203 (8)	11 (7/16)	280 (11-1/32)	175 (6-7/8)	15 (19/32)	11 (7/16)	50 (1-31/32)	101 (4)	32 (1-17/64)
CA5-1000	334 (13-5/32)	490 (19-9/32)	434 (17-1/16)	345 (13-9/16)	231 (9/32)	13 (25/64)	380 (14-31/32)	120 (4-23/32)	13 (25/64)	13 (25/64)	60 (2-3/8)	100 (3-31/32)	40 (1-9/16)
CA5-1200	334 (13-5/32)	490 (19-9/32)	434 (17-1/16)	345 (13-9/16)	231 (9/32)	13 (25/64)	380 (14-31/32)	120 (4-23/32)	13 (25/64)	13 (25/64)	60 (2-3/8)	100 (3-31/32)	40 (1-9/16)

Reversing Contactors & Accessories

Contactor with...	Dimension [mm]	Dimension [inches]
- auxiliary contact block	a	a
- reversing contactors with mechanical interlock		
next to each other		
CA 5-550-/CA 5-550	a+42+a	a+1-23/32+a
CA 5-700, -860/ CA 5-700, -860	a+32+a	a+1-1/4+a
CA 5-1000, -1200/ CA 5-1000, -1200	a+46+a	a+1-13/16+a
CA 5-550/CA, 5-700, -860	a+37+a	a+1-15/32+a
CA 5-700, -860/ CA 5-1000, -1200	a+73+a	a+2-7/8+a
above each other		
CA 5-550-/CA 5-550	b+56+b	b+2-3/16+b
CA 5-700, -860/ CA 5-700, -860	b+100...200+b	b+3-15/16...7-7/8+b
CA 5-1000, -1200/ CA 5-1000, -1200	b+230...280+b	b+9-1/16...11-1/32+b
CA 5-550/CA, 5-700, -860	b+100...200+b	b+3-15/16...7-7/8+b
CA 5-700, -860/ CA 5-1000, -1200	b+230...280+b	b+9-1/16...11-1/32+b
four main contacts		
CA 5-550-/CA 5-700, -860	a+68	a+2-11/16
CA 5-1000, -1200	a+76	a+3
latch		
CA 5-550	b+47	b+1-7/8
CA 5-700	b+64	b+2-17/32
CA 5-860	b+37	b+1-15/32
CA 5-1000, -1200	a+30	a+1-3/16

Mounting Position

